

# SIMPLE MARKER

- ◆ Great quality permanent marking now made affordable
- ◆ Most Economical
- ◆ Pneumatic Working
- ◆ Standalone
- ◆ Wifi Hotspot
- ◆ Most simple to buy, install & use



- ◆ Robust machine and holding stand.
- ◆ 100mm x 70mm marking window to cover most marking applications.
- ◆ Standard holding stand of 150mm height
- ◆ Communication over Wifi Hotspot of machine, No other Wifi network required.
- ◆ Use standard Mobile or Tablet or Laptop for operation.
- ◆ Simple to use with one button for all operations.
- ◆ Use a standard 19V 1.8A adapter for power.
- ◆ Drawing of accessories available for download,
- ◆ Multi color LED to indicate machine status
- ◆ Buy online on the website [www.simplermarker.com](http://www.simplermarker.com)



## Accessories

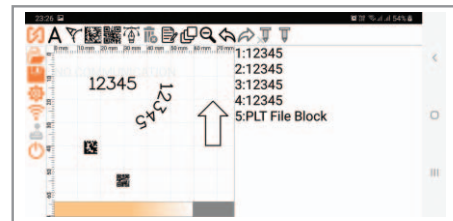
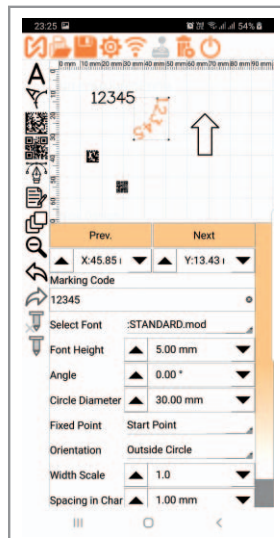
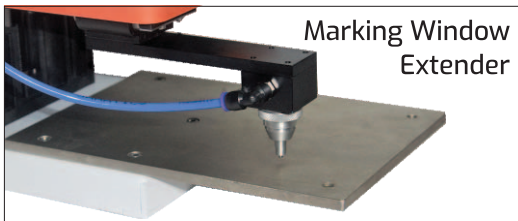
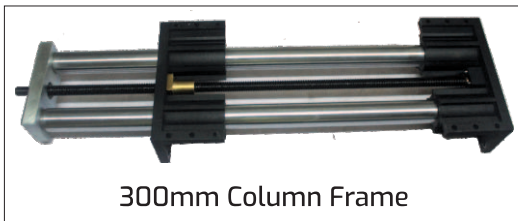

## Stylus Assemblies

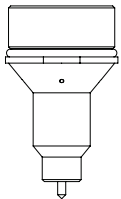

HF-06

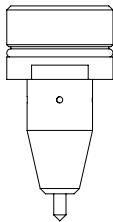

HF-12

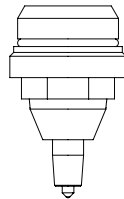

PHS-16

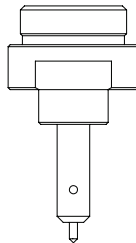

LP-06

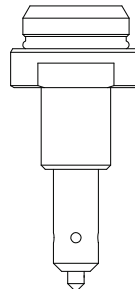

LP-10

## Monode Marking Products, Inc.

### Office:

9200 Tyler Blvd., Mentor, OH 44060

T: (440)975-8802 | F: (440) 975-8836

E: [sales@monode.com](mailto:sales@monode.com) | W: [www.monode.com](http://www.monode.com)